

**8 Homebush Drive Junortoun VIC**

3 2 6

Breathe in the serenity and soak up the space in this idyllic country family sanctuary.

Set back off the road in sought after Homebush Drive sits the beautifully presented 1.2 hectare property boasting the ultimate in family comfort, practicality and privacy, as well as its unique subdivision potential.

Step through the double timber doors into the raised formal entry and you'll instantly soak up the home's welcoming appeal with its open concept living floor plan, high pine board ceilings and an awe-inspiring feature brick fireplace setting the country vibe.

The central kitchen is set to impress the chef of the family with its practical design and unique extra-long bench and breakfast bar making for the perfect entertaining spot with

**Price** : \$ 605,000  
**Land Size** : 12321 sqm  
**View** : <https://www.dck.com.au/sale/vic/greater-bendigo-region/junortoun/residential/house/5767444>



**Marc Cox**  
**(03) 5440 5000**



**Justin Pell**  
**(03) 5440 5000**

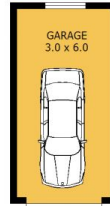

(NOT IN POSITION)

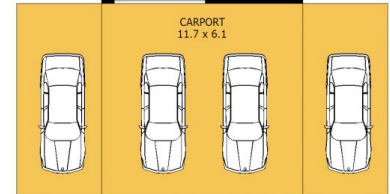
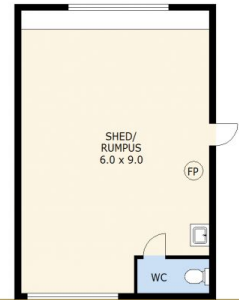

(NOT IN POSITION)



Scale in metres. Indicative only. Dimensions are approximate. All information contained herein is gathered from sources we believe to be reliable. However we cannot guarantee its accuracy and interested parties should rely on their own enquiries.

Residence	- 206 m <sup>2</sup>
Garage	- 18 m <sup>2</sup>
Verandah	- 116 m <sup>2</sup>
Shed	- 54 m <sup>2</sup>
Carport	- 72 m <sup>2</sup>
Portico	- 13 m <sup>2</sup>
Entertaining Area	- 51 m <sup>2</sup>
Total	- 530 m <sup>2</sup>



# 8 Homebush Drive, Junortoun